

PROMENADE AT COCONUT CREEK

COCONUT CREEK
BROWARD COUNTY, FLORIDA



**HILL
PARTNERS**

DEVELOPMENT MANAGEMENT
RETAIL PLANNING
LEASING

CONTACT:

2201 SOUTH BOULEVARD
SUITE 400, CHARLOTTE N.C.
28203
704.551.2202
www.hillpartnersinc.com
FOR MORE LEASING
INFORMATION

UPDATED: 14 Aug 23 - 12:41PM

LEASING STATUS PLAN

LS-1

This drawing is only illustrative of the size and relationship of the leaseable areas, common areas, other buildings and facilities, and are subject to change from time to time. The precise location and dimensions of the premises appear on the Lease Outline Drawings attached to the Lease. The Landlord makes no representation or warranties via this document that any specific Tenant noted herein or any number of Tenants will actually occupy spaces in the Shopping Center or that any portion of the Improvements as indicated will be built, all of which are subject to change. Landlord reserves the right to alter this plan in any manner it desires at its sole discretion without prior notice. Tenant/Tenants architect responsible for field verifying any and all dimensions and locations.

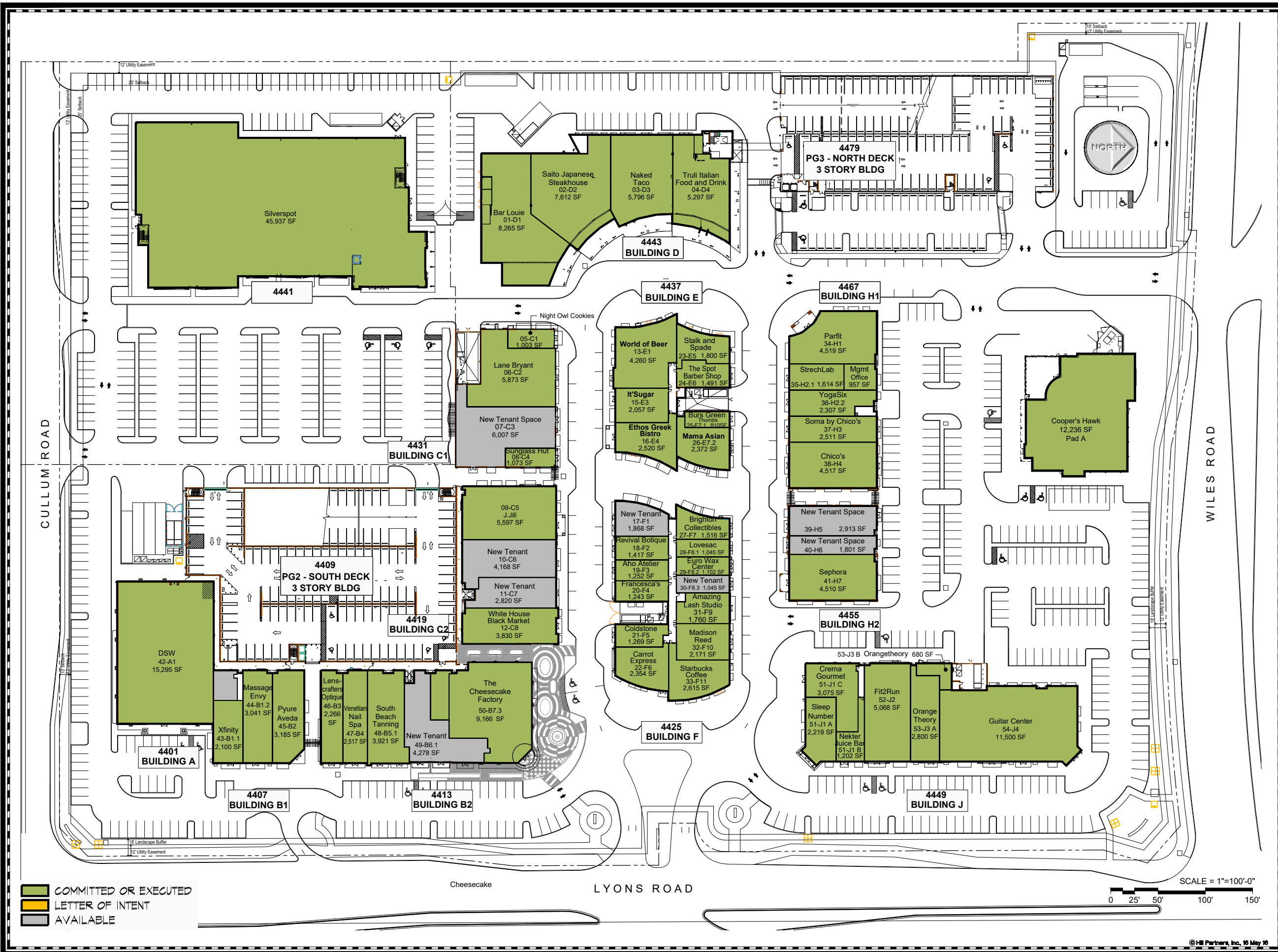

COMMITTED OR EXECUTED
 LETTER OF INTENT
 AVAILABLE

SCALE = 1"=100'-0"
0 25' 50' 100' 150'

© Hill Partners, Inc. 16 May 16